

## LH Series = Aluminum Beacon Strobe Light Holder

ALH5 series beacon light holders are heavy duty and mounted on top of rack box or truck. Holders can be ordered in any size to fit any application. All AMERICAN TRUCKBOXES holders are designed and built to keep your lights secure.

### Description

- .190 (3/16 gauge) aluminum construction

No.	Part Number	Application	Bolt Size	Weight Per Set	Load Rating
1.	A-LH61-201036-S	Top Bolt-On	3/8"	16	N/A
2.	A-LH62-20926-S	Top Bolt-On	3/8"	12	N/A

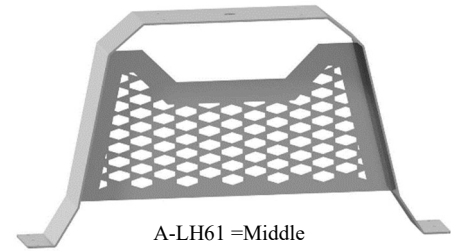

A-LH61 =Middle

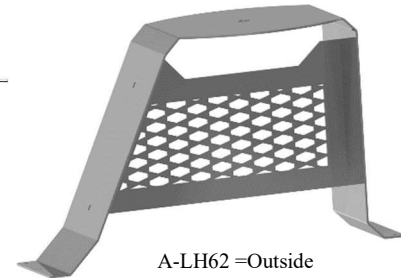

A-LH62 =Outside

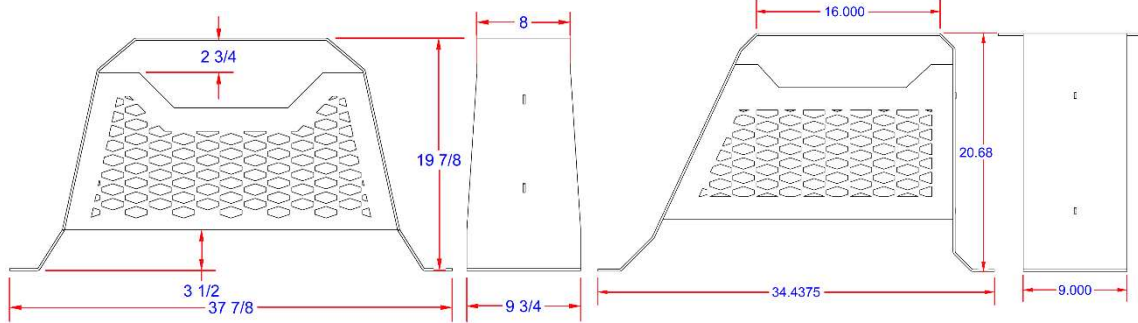

## LB Series = Light Bar - Top Mount Application

Light bars are heavy duty, and can be mounted on top of rack boxes or many other applications. Bar can be ordered in different sizes and lengths. All AMERICAN TRUCKBOXES light bars are designed and built to light up and make your truck looking great.

### Description

- Stainless steel mirror finish
- LED lighting with all quick disconnects and all soldered wiring
- Light hoods (optional)

No.	Part Number	Box Series	Bolt Size	Weight (lbs.)	Load Rating
1.	SS-LB4L-7278-10R	Top Mounted For 80" Rack 7.5" x 2" x 78"	3/8	30 lbs.	N/A
2.	SS-LB4L-7282-10R	Top Mounted For 84" Rack 7.5" x 2" x 82"	3/8	38 lbs.	N/A



## BB Series = Bumper Light Bar - Rear Mount Application.

Bumper light bars are heavy duty and can be mounted on rear of truck frame. Light bar can be ordered in different sizes and lengths. Light bar comes with LED's, mud flaps and mounting brackets. All AMERICAN TRUCKBOXES light bars are designed and built to light up your truck and make your truck looking great and safe.

### Description

- Stainless steel mirror finish, steel powder coated back mounts
- LED lighting with all quick disconnects and all soldered wiring
- Heavy duty mounting brackets and back plate
- Mud flaps and bottom mirror plates
- 5 wire connection with ground

No.	Part Number	Box Series	Bolt Size	Weight (lbs.)	Load Rating
1.	SS-BB4L-8298-13R	Rear Mounted 7.5" x 2" x 98"	1/2	95 lbs.	N/A

