

## CP – Cross-Pack Service Boxes – Steel & Aluminum – Both End Double Open Doors

Cross-pack service boxes are heavy duty, high capacity and offer easy access to your equipment. Boxes are mounted behind truck cab on truck frame. These boxes are perfect for storing your equipment, tools and personal gear. Cross-pack boxes are available in different sizes and can be ordered custom size. All AMERICAN TRUCKBOXES boxes are designed and built to keep your equipment safe and secure.

### Description

- An engineered steel or aluminum construction
- Fully seam welded on all seams and corners
- Stainless steel continuous hinge on full length of door
- Channel braced reinforced door with gas springs
- Lockable SS Dolphin Tail HD adjustable T-handle latch
- Built-in frame mounting rails for easy installation
- Rain gutter and automotive type weather seal
- Stationary shelves and two J-hooks on either side
- Optional drawers in box available
- Zinc epoxy primer with MR powder baked topcoat finish
- Mounting kit not included: Kit available M3450C



Single Door (Standard)



Double Door (Optional)

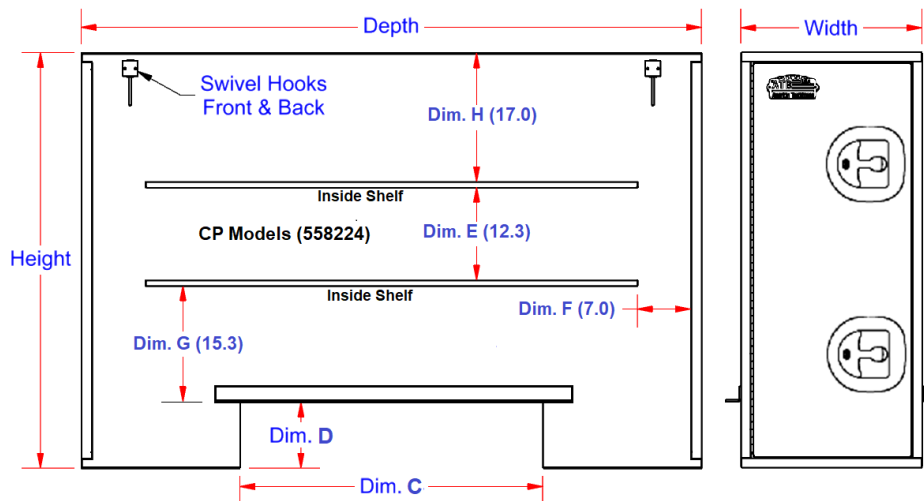

No.	Model Number	Material	Height (in.)	Depth (in.)	Width (in.)	Dim. C (in.)	Dim. D (in.)	Dim. E (in.)	Dim. G (in.)	Dim. H (in.)	Weight (lb.)
1.	A-CP52-558224S-S	10g Aluminum	55	82	24	40	8.75	12.3	15.3	17.0	298
2.	A-CP52-558524S-S	10g Aluminum	57	85	24	40	8.75	12.3	17.3	17.0	312
3.	A-CP52-579524S-S	10g Aluminum	57	95	24	40	8.75	12.3	17.3	17.0	348
4.	A-CP52-629524S-S	10g Aluminum	62	95	24	40	16.75	12.3	22.3	17.0	390
5.	S-CP42-558224S-*	14g Steel	55	82	24	40	8.75	12.3	15.3	17.0	528
6.	S-CP42-578524S-*	14g Steel	57	85	24	40	8.75	12.3	17.3	17.0	545
7.	S-CP42-579524S-*	14/12g Steel	57	95	24	40	8.75	12.3	17.3	17.0	645
8.	S-CP42-629524S-*	14/12g Steel	62	95	24	40	16.75	12.3	22.3	17.0	675

Note: \*Boxes are available in: Black (BX) and White (WX) Finish – add after part number.